

*Featured Project*

## ARHAUS FURNITURE

Leawood, Kansas



Approximately 10 miles south of Kansas City in Leawood is home to the new, two-story Arhaus Furniture store, which was beautifully designed and built from the ground-up and occupies more than 18,000 square feet. This is the first ground-up construction for Arhaus, and the building includes state-of-the-art energy management controls for lighting and mechanical systems.



The building architecture incorporates a unique combination of brick, granite and glass on the exterior, with reclaimed oak flooring inside to provide a contemporary, cutting-edge industrial design.

The spectacular design features within the building includes an expansive amount of brick and stone wall accents, a custom iron staircase wrapping the free-standing elevator tower, which leads to a 30 foot atrium on the second floor, and a three-season outdoor patio, complete with custom gates, fountains and an Indonesian jugla hut made from hand-carved teak.



photo credit: [Julie Legg Photography](#)

## THE "STATE" OF ARCHITECTURE

Since it's summer, we're focusing on the sunshine **state of Florida** in this issue of our newsletter. For more than a decade, RDL Architects has had a strong performance throughout the entire state of Florida.



Our Florida experience includes:

- master planning
- market rate communities
- cottages
- clubhouses
- town homes
- condominiums
- apartments
- senior villages
- retail, such as several Arhaus Furniture stores

Paseo | Fort Myers, FL

Voted "Community of the Year" for nine consecutive years!

We currently have a number of large market rate residential projects under construction in Estero, Florida and are excited to showcase them when they're complete!

---

## UPCOMING CONFERENCE

We look forward to attending and showcasing our latest work portfolio at the following [Leading Age OH Conference](#) from September 9-11 in Columbus, Ohio. We hope to see you and please stop by Booth 102 and say hello!

---

## REVITALIZING THE POLO CLUB FITNESS CENTER



Designed to meet the needs of its residents, the Polo Club Apartments in Strongsville, Ohio engaged RDL to reimagine and transform an outdated racquetball court into a new, modern fitness center. In order to create an efficient use of space, a smaller exercise room across the hall was also updated with our design to provide a larger, more unified exercise facility, with

common materials in each room.

Key elements of the space include recycling and repositioning windows to allow natural light to shine in. Other architectural enhancements were emphasized in the variation of textures and paints, fixtures and lighting, window treatments, varying ceiling heights and spatial relationships between the different pieces of equipment.

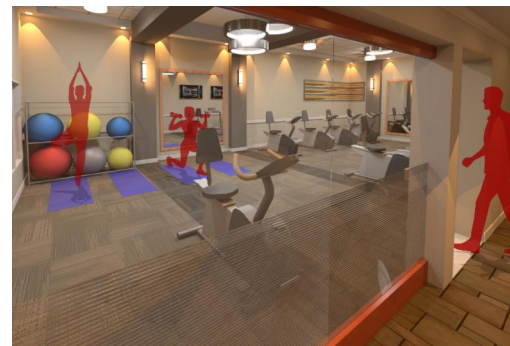

Renderings by RDL staff John Peterson

---

## RDL CONTINUES TO GROW!

We're excited to welcome Bob and Doug to our growing team!



**Bob Reighard**  
Senior Designer

After more than 25 years in the design field, Bob still loves Mondays. Prior to joining RDL, Bob had previously owned and operated his own architectural and interior design firm since 2006, specializing in commercial, mixed-use, hospitality, planning, design and visualization. Bob is a graduate of Michigan State University with a Bachelor of Fine Art in Industrial Design.



### **Douglas Shaulis, LEED AP**

Project Designer

Doug is a LEED Accredited Professional with experience in the research and implementation of sustainable materials and building practices. He utilizes his 20+ years of experience in the construction field to bring his designs to life in an efficient and well-produced manner. His diverse background in both construction and architecture creates a seamless transition of a project from conception, through design and into reality. Doug received his Bachelor of Architecture from Kent State University.

---

### **CONVERSATION STARTER...**

A recent article from Architect Magazine, *NCARB Examines How the Architectural Profession Is Changing*, highlights the state of the architecture profession in its annual report.

Several highlights include:

- The number of aspiring architects on the path to licensure continues to grow.
- Candidates are completing licensure requirements earlier and at a younger age.
- Graduates from NAAB-accredited architecture programs have advantages over their peers from non-accredited programs.
- The highest number of women to date are now on the path to licensure.
- Tomorrow's architects will have more racially and ethnically diverse backgrounds.

Click to read the [full article](#) or go straight to read [NCARB's full annual report](#).

What are your thoughts on the changes you've seen to the architecture industry? We'd love to hear your comments and feedback, so please [click here](#) to send us your thoughts!

## **People / Places / Possibilities**

[RDLarchitects.com](http://RDLarchitects.com)

16102 Chagrin Blvd., Suite 200 | Cleveland, Ohio 44120

p 216.752.4300 | f 216.752.4301